

Līnijveida drenāžas sistēma G 100

Iekšējais platums 10 cm

Slodzes klase A 15, B 125, C 250 saskaņā ar EN 1433

| Tips | Gabarīti | | Gabarītaugstums | | Slīpuma tips ⁽⁶⁾ | Gab./Pal. | Kg/gab. | EDV-pasūt. Nr. | LVL/gab. |
|------|------------|-------------|-----------------|------------|-----------------------------|-----------|---------|----------------|----------|
| | Garums, cm | Platums, cm | Sākumā, cm | Beigās, cm | | | | | |

Polimērbetona kanāls G 100

| | | | | | | | | | |
|----------------------|-------|------|------|------|-----|----|------|-------|--------------|
| G-mini | 100,0 | 13,0 | 5,7 | 5,7 | 1 | | 7,1 | 08299 | 12,00 |
| G-mini ⁴⁾ | 100,0 | 13,0 | 5,7 | 5,7 | 1 | | 9,9 | 08300 | 43,00 |
| 0.0 ³⁾ | 100,0 | 13,0 | 15,0 | 15,0 | 1/3 | 24 | 12,1 | 06000 | 23,00 |
| 0.1 ²⁾³⁾ | 50,0 | 13,0 | 15,0 | 15,0 | 1/3 | 24 | 6,0 | 06049 | 19,00 |
| 1 | 100,0 | 13,0 | 15,0 | 15,5 | 2 | 24 | 12,2 | 06001 | 23,00 |
| 2 | 100,0 | 13,0 | 15,5 | 16,0 | 2 | 24 | 12,5 | 06002 | 23,00 |
| 3 | 100,0 | 13,0 | 16,0 | 16,5 | 2 | 24 | 12,7 | 06003 | 23,00 |
| 4 | 100,0 | 13,0 | 16,5 | 17,0 | 2 | 24 | 13,0 | 06004 | 23,00 |
| 5 ³⁾ | 100,0 | 13,0 | 17,0 | 17,5 | 2 | 24 | 13,3 | 06005 | 23,00 |
| 5.0 ³⁾ | 100,0 | 13,0 | 17,5 | 17,5 | 1 | 24 | 13,8 | 06050 | 23,00 |
| 5.1 ²⁾³⁾ | 50,0 | 13,0 | 17,5 | 17,5 | 1 | 24 | 7,0 | 06047 | 19,00 |
| 6 | 100,0 | 13,0 | 17,5 | 18,0 | 2 | 24 | 13,9 | 06006 | 23,00 |
| 7 | 100,0 | 13,0 | 18,0 | 18,5 | 2 | 24 | 14,1 | 06007 | 23,00 |
| 8 | 100,0 | 13,0 | 18,5 | 19,0 | 2 | 24 | 14,5 | 06008 | 23,00 |
| 9 | 100,0 | 13,0 | 19,0 | 19,5 | 2 | 24 | 14,9 | 06009 | 23,00 |
| 10 ³⁾ | 100,0 | 13,0 | 19,5 | 20,0 | 2 | 24 | 15,2 | 06010 | 23,00 |
| 10.0 ³⁾ | 100,0 | 13,0 | 20,0 | 20,0 | 1/3 | 24 | 15,4 | 06100 | 23,00 |
| 10.1 ²⁾³⁾ | 50,0 | 13,0 | 20,0 | 20,0 | 1/3 | 24 | 8,0 | 06048 | 19,00 |
| 11 | 100,0 | 13,0 | 20,0 | 20,5 | 2 | 24 | 15,5 | 06011 | 23,00 |
| 12 | 100,0 | 13,0 | 20,5 | 21,0 | 2 | 24 | 15,7 | 06012 | 23,00 |
| 13 | 100,0 | 13,0 | 21,0 | 21,5 | 2 | 24 | 16,0 | 06013 | 23,00 |
| 14 | 100,0 | 13,0 | 21,5 | 22,0 | 2 | 24 | 16,3 | 06014 | 23,00 |
| 15 | 100,0 | 13,0 | 22,0 | 22,5 | 2 | 24 | 16,8 | 06015 | 23,00 |
| 16 | 100,0 | 13,0 | 22,5 | 23,0 | 2 | 24 | 17,1 | 06016 | 23,00 |
| 17 | 100,0 | 13,0 | 23,0 | 23,5 | 2 | 24 | 17,5 | 06017 | 23,00 |
| 18 | 100,0 | 13,0 | 23,5 | 24,0 | 2 | 24 | 17,9 | 06018 | 23,00 |
| 19 | 100,0 | 13,0 | 24,0 | 24,5 | 2 | 24 | 18,2 | 06019 | 23,00 |
| 20 ³⁾ | 100,0 | 13,0 | 24,5 | 25,0 | 2 | 24 | 18,5 | 06020 | 23,00 |
| 20.0 ³⁾ | 100,0 | 13,0 | 25,0 | 25,0 | 1/3 | 24 | 18,5 | 06021 | 23,00 |
| 20.1 ²⁾³⁾ | 50,0 | 13,0 | 25,0 | 25,0 | 1/3 | 24 | 9,0 | 06022 | 19,00 |

| Tips | Gabarīti | | | Gab./Pal. | Kg/gab. | EDV-pasūt. Nr. | LVL/gab. |
|------|------------|-------------|--------------|-----------|---------|----------------|----------|
| | Garums, cm | Platums, cm | Augstums, cm | | | | |

Polimērbetona smilšķērājs, garais G 100

| | | | | | | | |
|-------|------|------|------|----|------|-------|--------------|
| SF 58 | 50,0 | 13,0 | 58,5 | 10 | 24,6 | 06335 | 50,00 |
|-------|------|------|------|----|------|-------|--------------|

Polimērbetona smilšķērājs, īsais G 100

| | | | | | | | |
|-------|------|------|------|----|------|-------|--------------|
| SF 37 | 50,0 | 13,0 | 37,5 | 12 | 16,0 | 06336 | 42,00 |
|-------|------|------|------|----|------|-------|--------------|



G 100 Kanāls 1.0 m

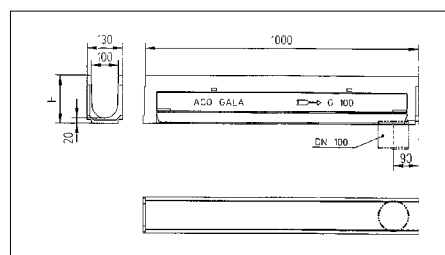

Kanāla G 100 1.0 m izmēri (www.aco.lv)



Kanāls G 100 0.5 m ar sānu sagatavēm stūra, T-veida un krustveida savienojumiem



Garais smilšķērājs G 100 0.5 m ar noteku DN 100



Īsais smilšķērājs G 100 0.5 m ar noteku DN 100

²⁾ Kanāls ar sānu sagatavēm stūra, T-veida un krustveida savienojumiem.

³⁾ Kanāls ar sagatavi vertikālai notecei DN 100.

⁴⁾ Kanāls ar iebūvētu PE-HD iscauruli DN 100 vertikālai notecei.

⁶⁾ Slīpuma tipu definīciju skatīt 3. lpp.

Līnijveida drenāžas sistēma G 100

Iekšējais platums 10 cm

Slodzes klase A 15, B 125, C 250 saskaņā ar EN 1433

| Tīps | Kg/gab. | EDV-pasūt. Nr. | LVL/gab. |
|------|---------|----------------|----------|
|------|---------|----------------|----------|

Polimērbetona pārejas elements G 100 kanālu augstumu starpības izlīdzināšanai

| | | | |
|------------------|-----|-------|--------------|
| Pārejas elements | 0,5 | 02604 | 11,00 |
|------------------|-----|-------|--------------|

Polimērbetona gala noslēgs G 100 ar integrētu cinkotu malu. Izmantošanai kanāla sākumā un beigās

| | | | |
|------------------------|-----|-------|-------------|
| Piemērots tipam 0 - 20 | 1,4 | 06340 | 4,00 |
| Piemērots tipam Mini | 0,8 | 08372 | 6,00 |

Polimērbetona kanāla gala noslēgs G 100 ar integrētu cinkotu malu, ar īscauruli DN 100

| | | | |
|--------------------------------|-----|-------|-------------|
| Piemērots tipam 0.1, 0.0 | 0,7 | 06241 | 9,00 |
| Piemērots tipam 5.1, 5.0, 5 | 0,8 | 06242 | 9,00 |
| Piemērots tipam 10.1, 10.0, 10 | 0,9 | 06243 | 9,00 |
| Piemērots tipam 20.1, 20.0, 20 | 1,1 | 06244 | 9,00 |

G 100 piederumi

| | | | |
|-------------------------------------|-----|-------|--------------|
| PVH īscaurule DN 100 | 0,2 | 00056 | 2,00 |
| Sifons garajam smilšķērājam, DN 100 | 0,5 | 02640 | 11,00 |
| Sifons īsajam smilšķērājam, DN 100 | 0,2 | 01684 | 8,00 |
| Sifons kanālam, trīsdalīgs | 0,2 | 01546 | 7,00 |

| Tīps | Gabarīti | | Režģa atvere, cm ² /m | Gab./Pal. | Kg/gab. | EDV-pasūt. Nr. | LVL/gab. |
|------|------------|-------------|----------------------------------|-----------|---------|----------------|----------|
| | Garums, cm | Platums, cm | | | | | |

Nosegrežģis kanālam un smilšķērājam G 100**Slodzes klase A 15**

| | | | | | | | |
|-------------------------------|-------|------|-----|-----|-----|-------|-------------|
| Cinkota tērauda spraišļrežģis | 100,0 | 13,0 | 280 | 200 | 2,2 | 06303 | 6,00 |
| | 50,0 | 13,0 | 280 | 400 | 1,0 | 06304 | 4,00 |

Slodzes klase B 125

| | | | | | | | |
|--|-------|------|-----|-----|-----|-------|--------------|
| Cinkota tērauda šūnveida režģis | 100,0 | 12,7 | 875 | 200 | 2,8 | 06305 | 20,00 |
| | 50,0 | 12,7 | 875 | 200 | 1,5 | 06306 | 15,00 |
| Nerūsējoša tērauda šūnveida režģis, AISI 304 | 100,0 | 12,7 | 875 | 200 | 3,4 | 98110 | 56,00 |
| | 50,0 | 12,7 | 875 | 200 | 1,7 | 98111 | 38,00 |

Slodzes klase C 250

| | | | | | | | |
|--------------------------|------|------|-----|-----|-----|-------|--------------|
| Čuguna GGG spraišļrežģis | 50,0 | 12,7 | 493 | 200 | 2,9 | 06314 | 11,00 |
|--------------------------|------|------|-----|-----|-----|-------|--------------|

Režģa slēgs. Lieto 2 gab. uz vienu tekošo metru

| | | | | |
|---|----|-----|-------|-------------|
| Spraišļrežģa slēgs, cinkotais tērauds | 50 | 0,2 | 06309 | 1,00 |
| Šūnveida režģa slēgs, cinkotais tērauds | 50 | 0,2 | 06308 | 2,00 |
| Čuguna GGG spraišļrežģa slēgs | 50 | 0,2 | 06312 | 1,00 |



Gala noslēgs G 100

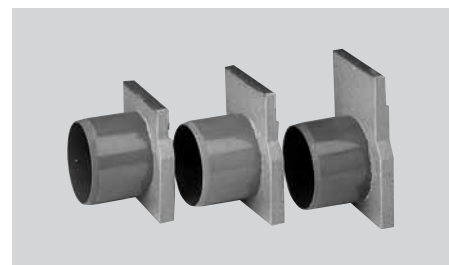

Gala noslēgs ar īscauruli G100

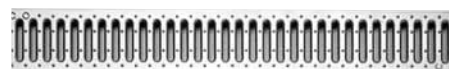

Spraišļrežģis, cinkots tērauds, klase A 15, produkta Nr. 06303



Šūnveida režģis, cinkots tērauds, klase B 125, produkta Nr. 06305



Čuguna GGG spraišļrežģis, klase C 250, produkta Nr. 06314